

**1 RAMP PLAN (GROUND FLOOR)**  
1 : 50 meters

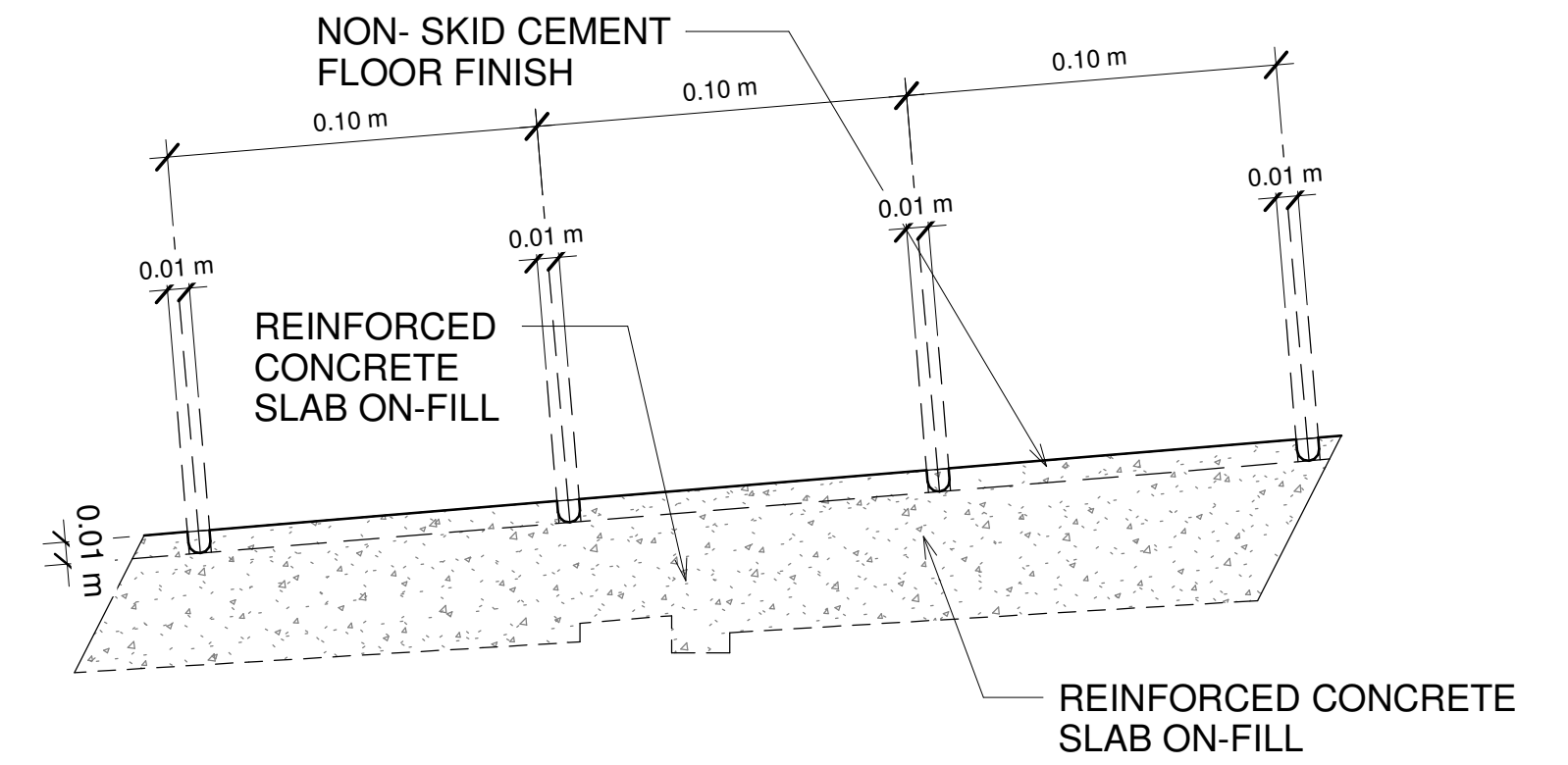

**3 TYPICAL SECTION OF RAMP FLOORING (R-1)**  
1 : 2 meters

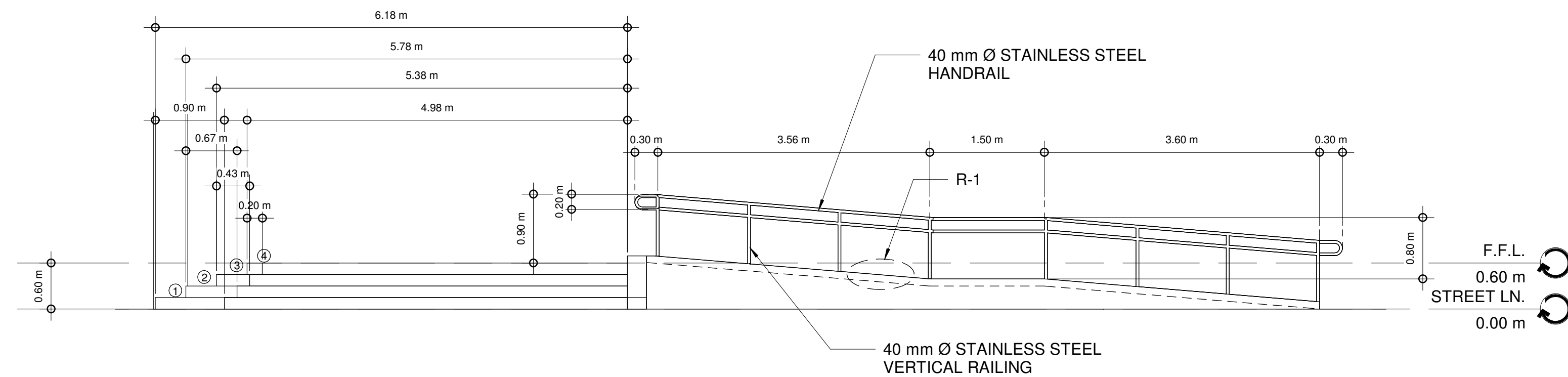

**2 ELEVATION OF RAMP**  
N T S

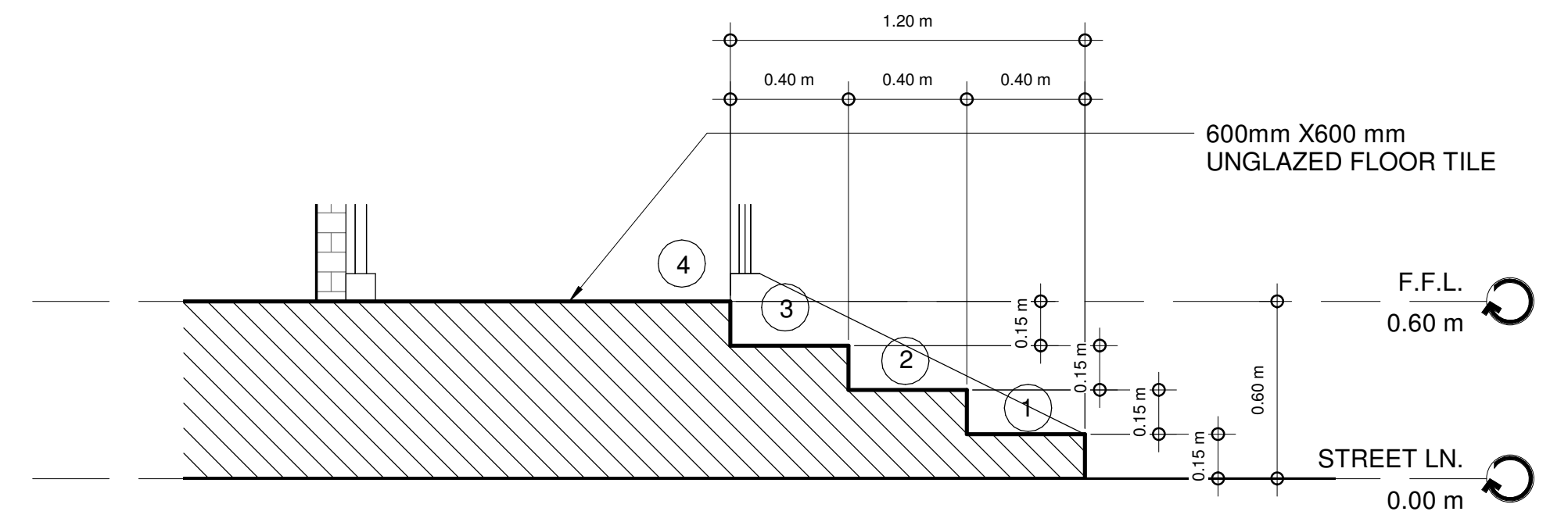

**4 SECTION THRU ENTRANCE STEPS**  
1 : 20 meters

STAINLESS STEEL (ARIAL FONT) 50 mm THICKNESS

RESEARCH, DEVELOPMENT AND EXTENSION

**5 BUILDING NAME DETAIL**  
1 : 20 meters

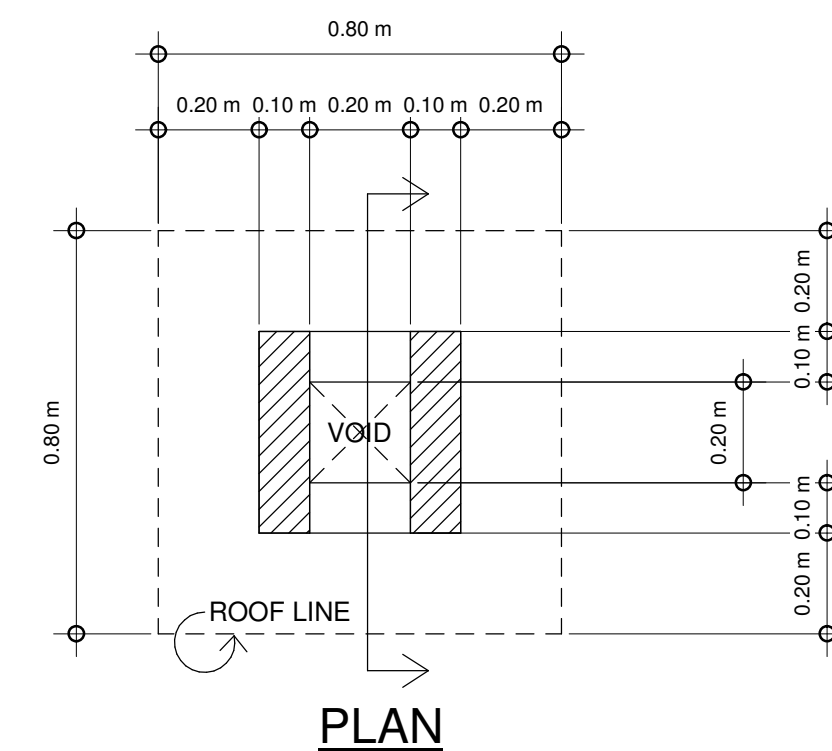

PLAN

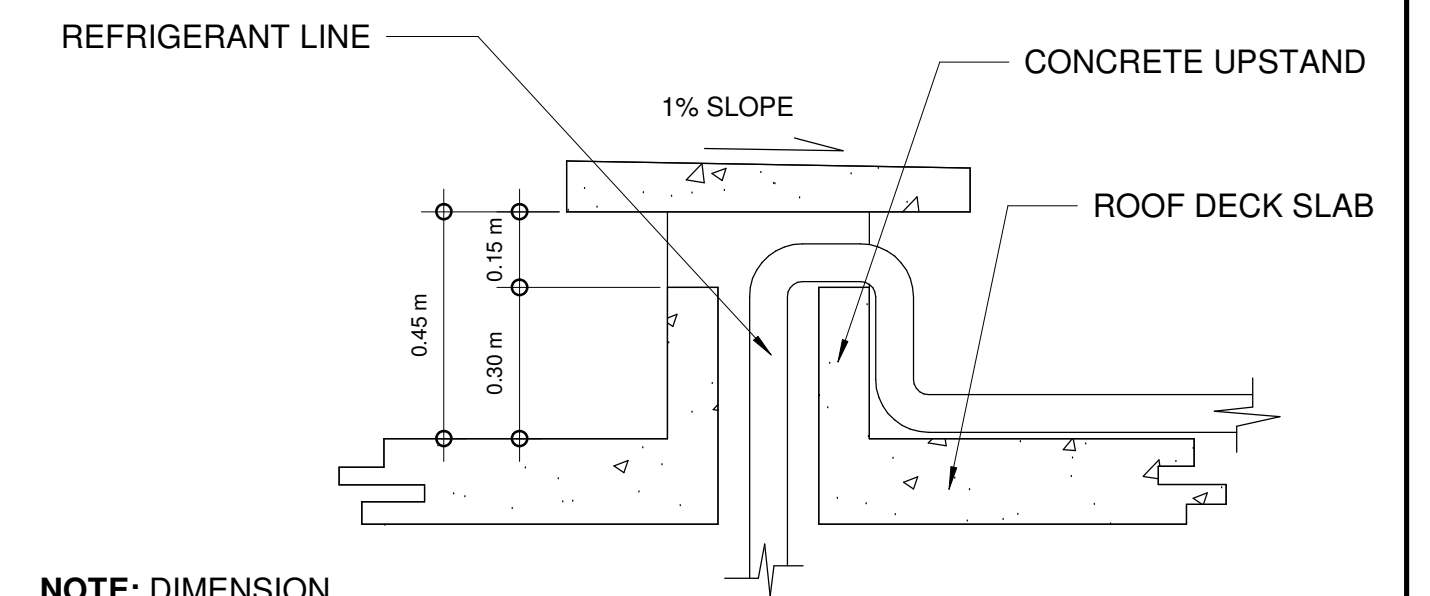

NOTE: DIMENSION REFER TO PLAN

TYPICAL SECTION DETAIL

**6 DOG HOUSE DETAILS**  
1 : 15 meters

	<b>FROM THE OFFICE:</b> <b>PHYSICAL PLANNING AND DEVELOPMENT OFFICE</b> 2/F ADMINISTRATION BLDG. MARIANO MARCOS STATE UNIVERSITY CITY OF BATAAC, 2906 ILOCOS NORTE TELEFAX: +63 (77)792-3191	<b>DRAWN BY:</b> <b>BJAYA DAYANG</b> DRAFTSMAN I <b>PREPARED BY:</b> <b>PHILIP P. PADRE</b> ENGINEER I	<b>SIGNED &amp; SEALED BY:</b> <b>AIDAY CABANG</b> ARCHITECT PRC NO.: 12274 PTR: 0147662 PLACE ISSUED: CITY OF BATAAC DATE: JANUARY 06, 2022 TIN: 284-723-161	<b>PROJECT TITLE:</b> <b>CONSTRUCTION OF RDE BUILDING PHASE III</b> <b>LOCATION:</b> MMSU CRL-CITY OF BATAAC, ILOCOS NORTE	<b>CHECKED/REVIEWED BY:</b> <b>AIDAY CABANG</b> ARCHITECT IV, CHIEF-PHYSICAL PLANNING SECTION <b>RECOMMENDING APPROVAL:</b> <b>ROMEO R. DULDUALO</b> DIRECTOR, PPDO	<b>CONFORME:</b> <b>BJORN S. SANTOS</b> DIRECTOR, RESEARCH <b>APPROVED BY:</b> <b>SHIRLEY C. AGRUPIS</b> UNIVERSITY PRESIDENT	<b>SHEET CONTENTS:</b> RAMP PLAN (GROUND FLOOR) ELEVATION OF RAMP TYPICAL SECTION OF RAMP FLOORING (R-1) SECTION THRU ENTRANCE STEPS BUILDING NAME DETAIL DOG HOUSE DETAIL <small>Drawings and specifications and other contract documents duly signed, stamped or sealed, as instruments of service, are the intellectual property and documents of the architect, whether the object for which they are made is executed or not. It shall be unlawful for any person to duplicate or to make copies of said documents for use in the repetition of and for other project or building, whether executed partly or in whole, without the written consent of architect or author of said document. Art. IV-Sec. 338A(2)(b)</small>	<b>SHEET NO:</b> A-14 14 16
--	--	---	--	--	--	--	--	-----------------------------------